

2000-2002 MITSUBISHI ECLIPSE - V6 3.0L

Warning: When working on under or around any vehicle exercise caution. Please allow the vehicle's exhaust system to cool before removal, as exhaust system temperatures may cause severe burns. If working without a lift, always consult vehicle manual for correct lifting specifications. Always wear safety glasses and ensure safe work area. Serious injury or death could occur if safety measures are not followed.

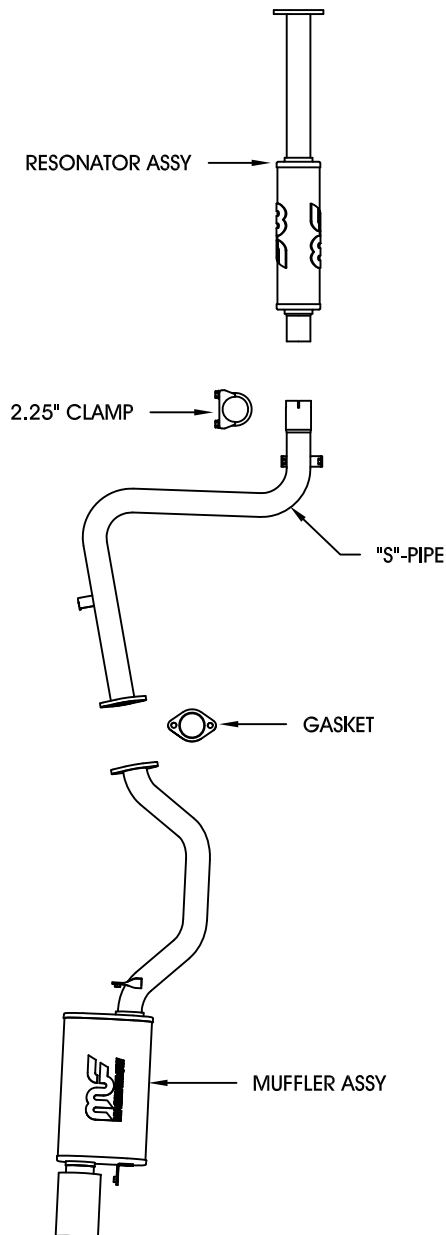

Step 1: (Carefully read all instructions before installation) Begin removal of the OEM exhaust system by unbolting the OEM muffler from the exhaust at the 2-bolt flange in front of the control arm. You will also need to unbolt the muffler from the car at the mounting brackets. Do not discard the OEM fasteners, as they will be re-used to mount the new system. Unbolt all mounting brackets and remove the resonator assembly from the vehicle.

Step 2: Begin installation by bolting the new resonator assembly to the catalytic converter using the OEM fasteners. Leave all fasteners loose for final adjustment of the complete system. Using the supplied clamp and OEM bracket fasteners, mount the "S" pipe to the resonator assembly. Use the OEM bracket fasteners to mount the muffler in position, and the supplied fasteners to bolt the muffler to the "S" pipe.

Step 3: With all components mounted loosely, adjust the system for overall aesthetics and clearance of frame & bodywork. (MAGNAFLOW recommends at least 1/2" of clearance between the exhaust system and any body panels to prevent heat-related body damage or fire.)

Step 4: Once a final position has been chosen for the new system, evenly tighten all fasteners from front to rear. Inspect all fasteners after 25-50 miles of operation and retighten if necessary.

*MAGNAFLOW Performance Exhaust recommends professional installation on all their products

Technical support: 1-800-959-9226 ext. 4500